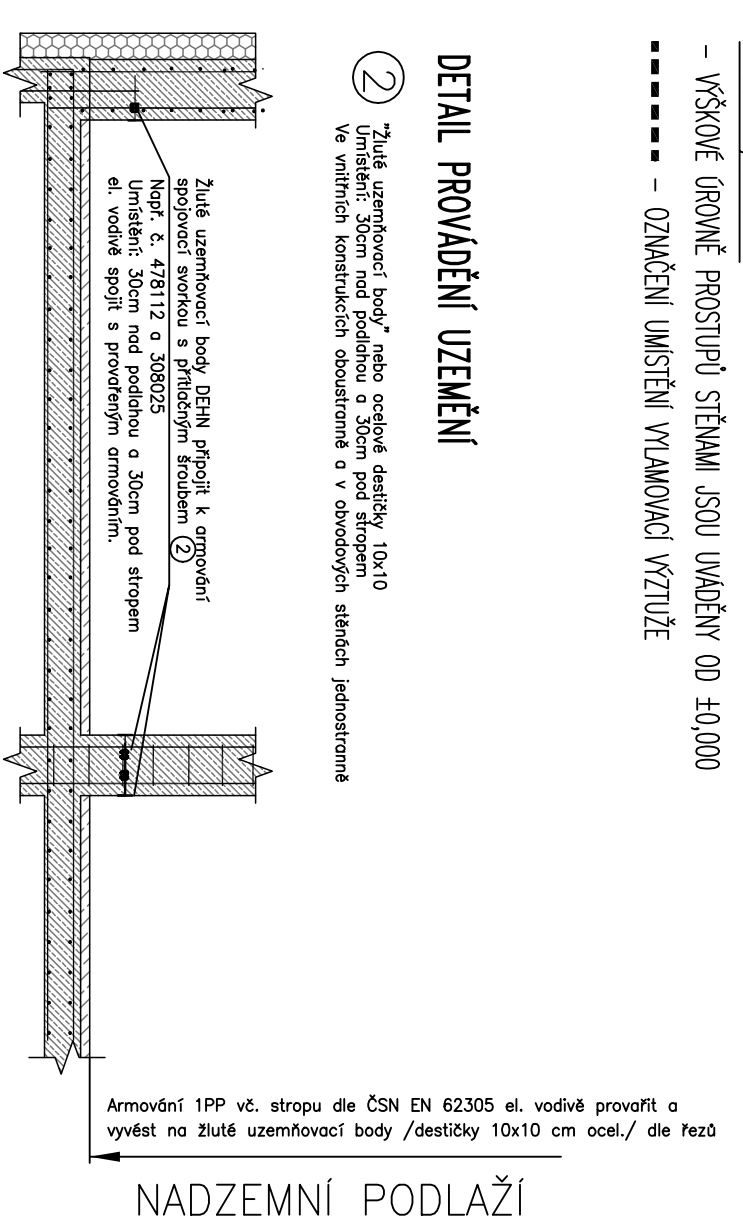
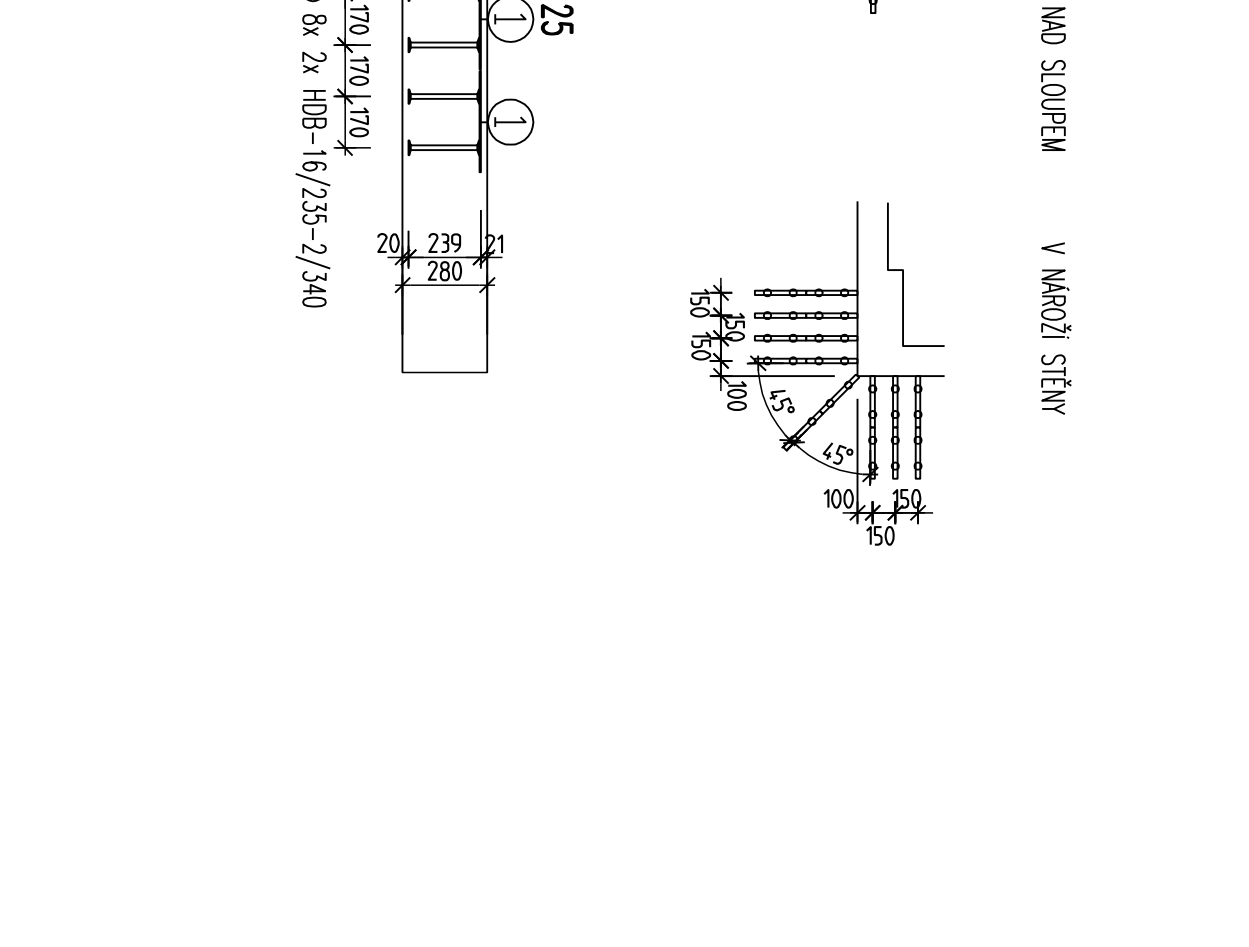
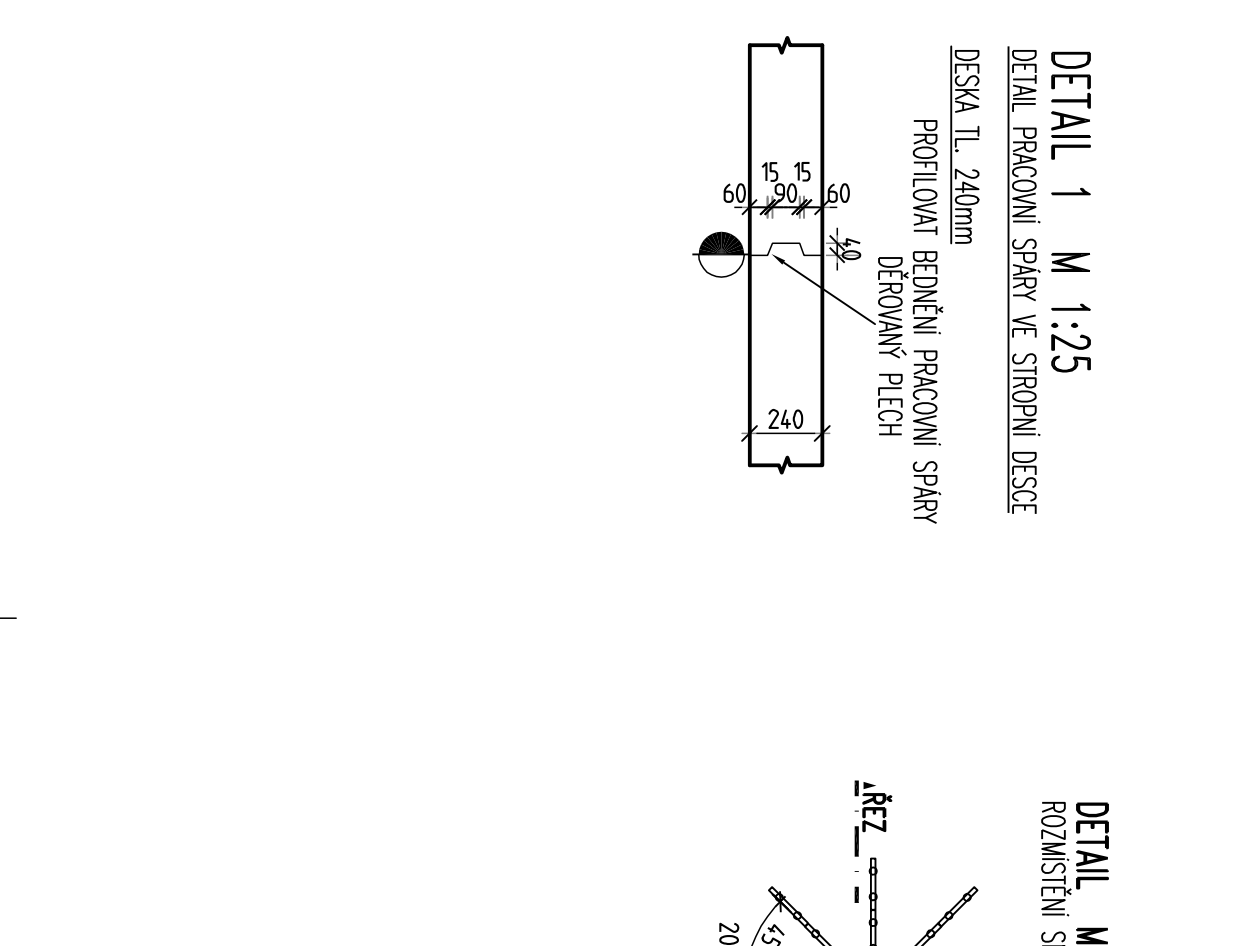
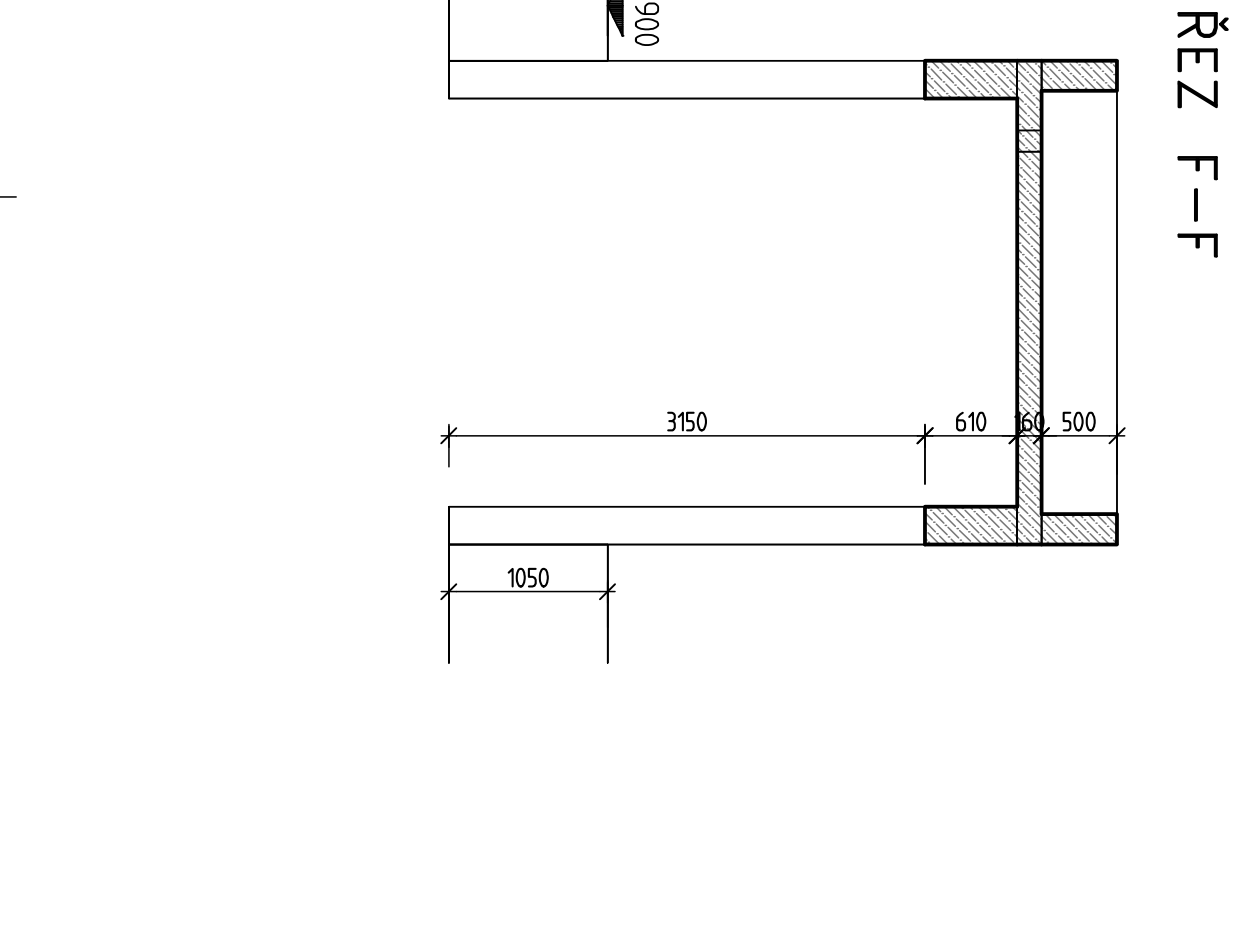
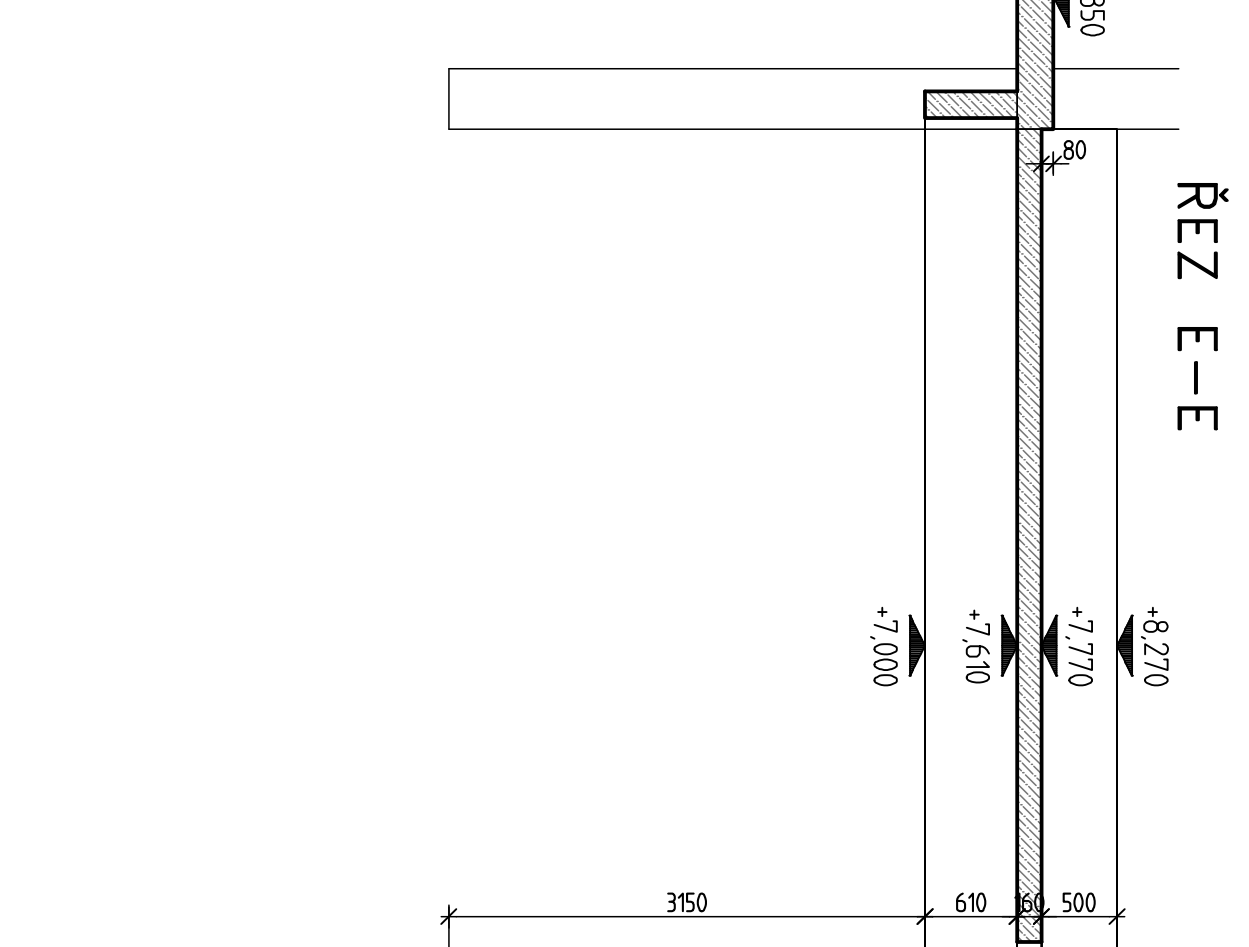
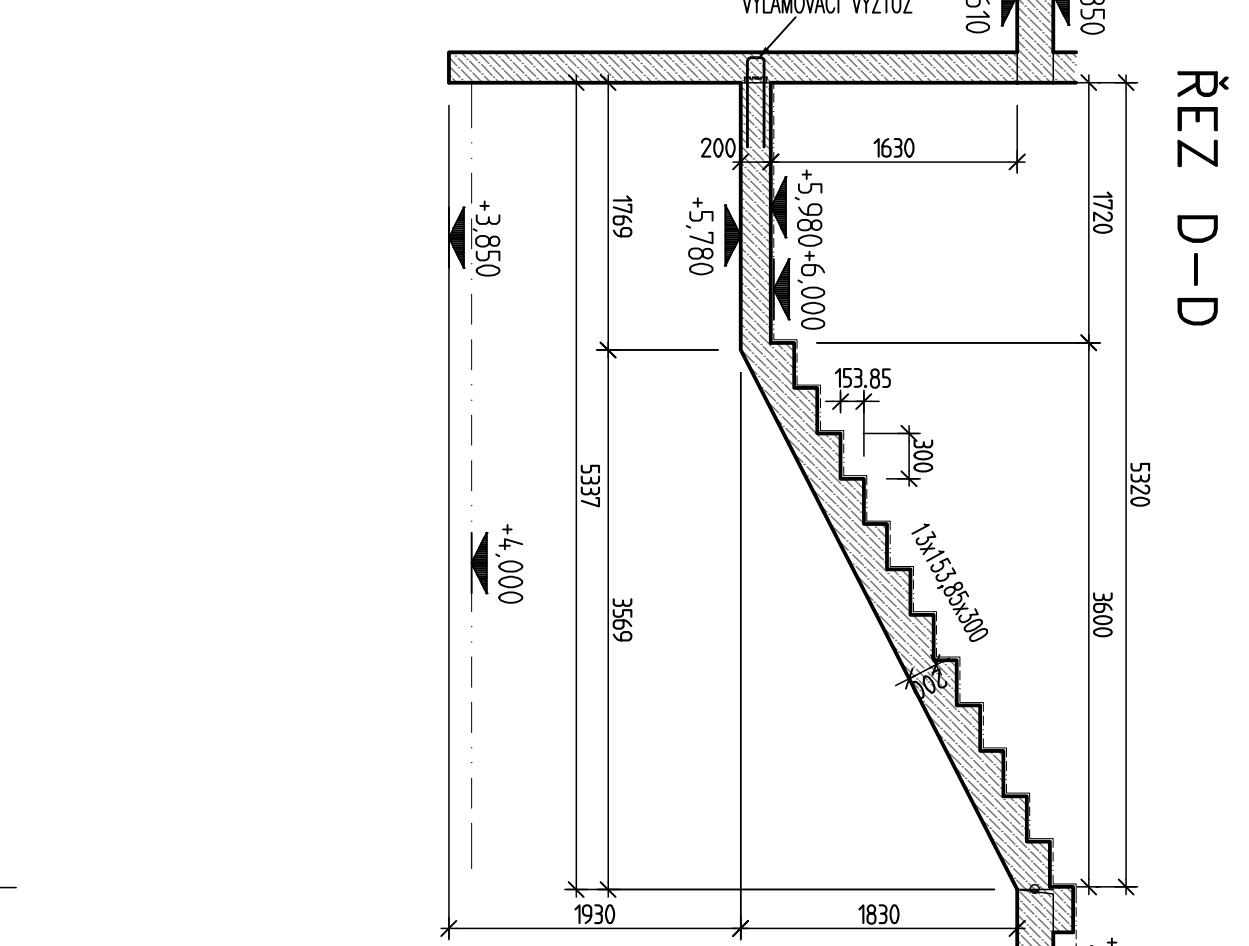
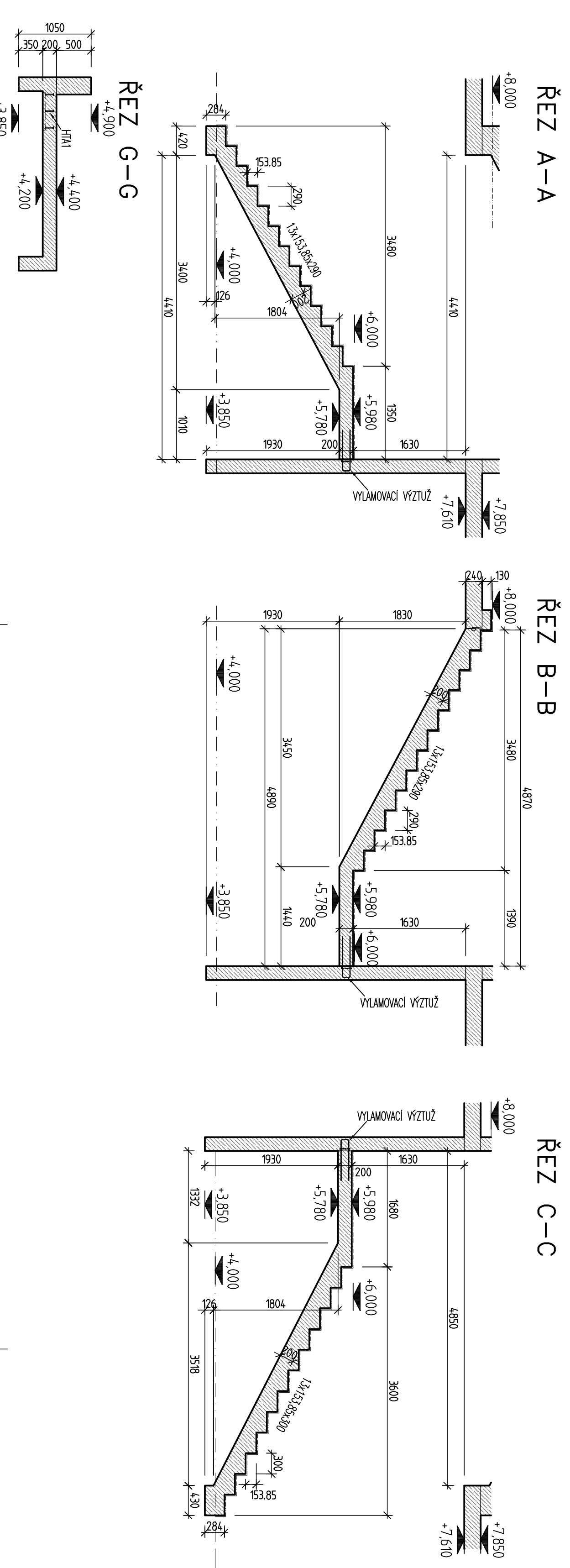
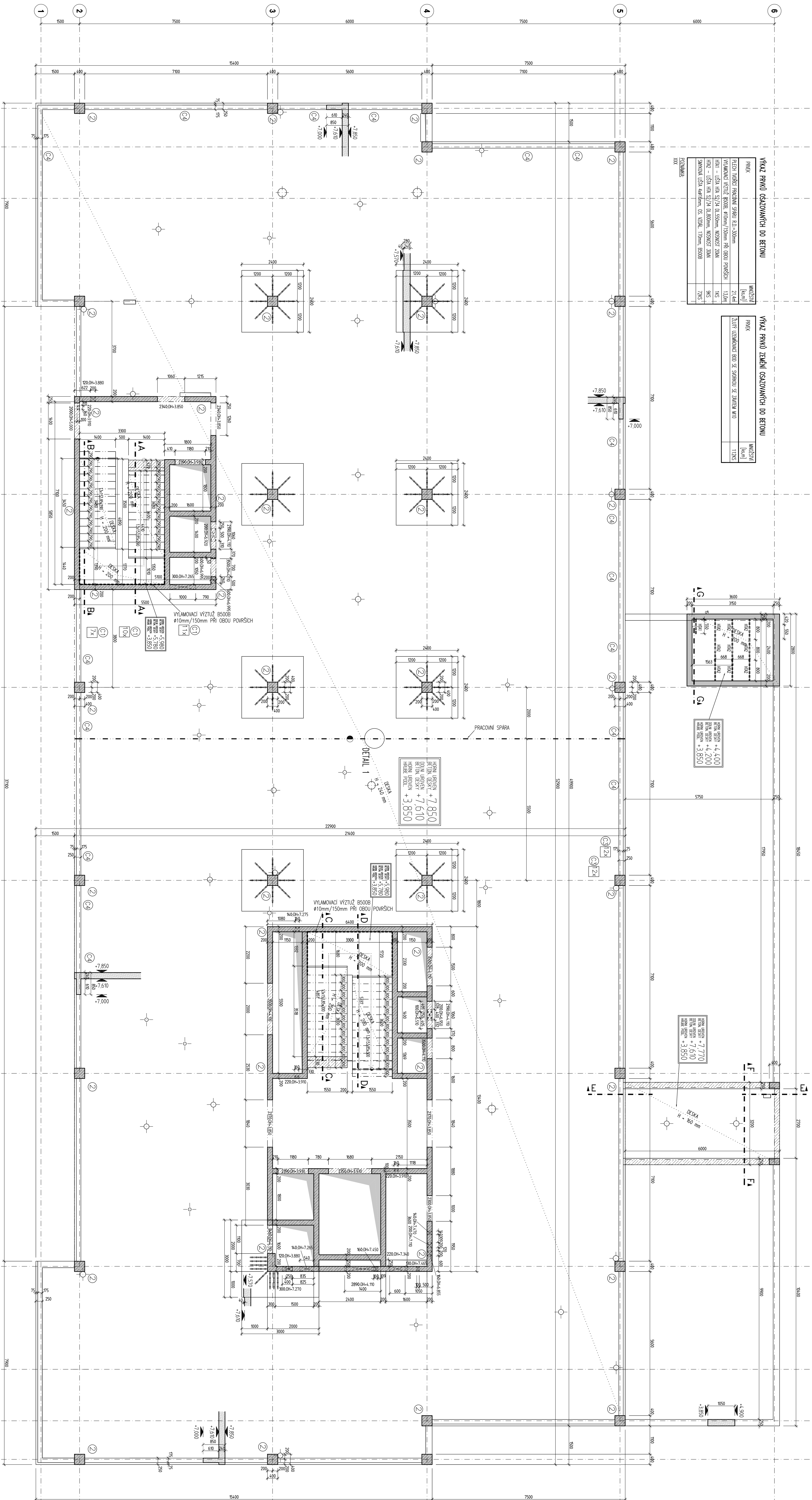
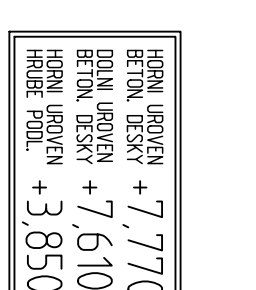
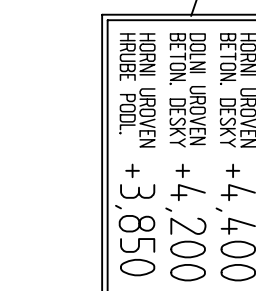
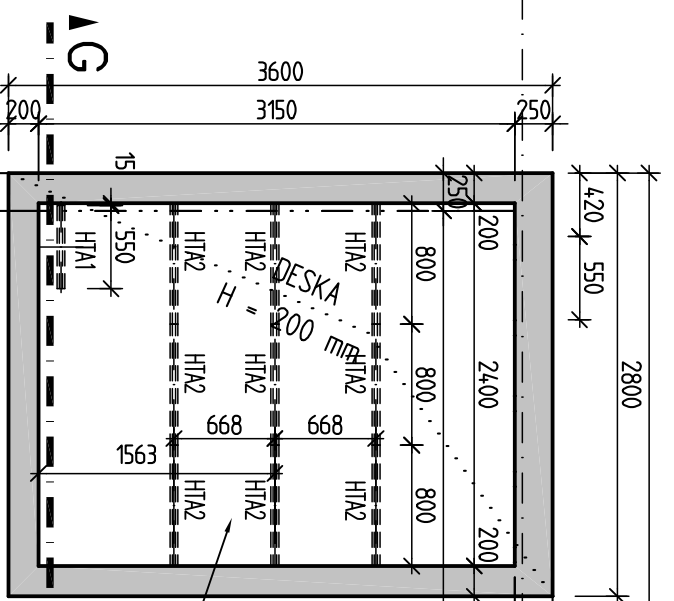

PRŮBĚH	HMOTNOST [kg/m ³]
PLATEK DOBŘE PROJEDENÝ ŠPÍNEM 10,0-30,0mm	21,44
VÝMNOŽENÝ VĚTRILÉ ŽEOLIT, 17,0mm / 15,0mm PŘI OBEDU ROVNĚŽ ŠPÍN - 10,0mm PŘI ŠPÍN 2,0-15,0mm, MŮŽNOST 20,0k	13,51
HŘÍZ - 10,0mm PŘI ŠPÍN 2,0-15,0mm, MŮŽNOST 20,0k	9,92
SMOKVA, 15,0k, 40,0mm, 0,5 VODNĚ, 17,0mm, 50,0k	7,95
POZVORKA	
XXX	

PRŮK	HMŮŽNOST [kg/m]
ŽULY UZAMKOVANÝ BLOK SE SPORKOU SE ŽULITELNÍM	112,85

[illegible][illegible]

Q451. VARIATION POSSES - HH ... HORN HORN OTTORU, GSA ... GSA OTTORU, DNO OTTORU

[illegible]

PROVÁDĚNÍ TRUBKOVANÍ
- PROJEKT DLE VÝKRESU ELEKTRO -

(C1)	(C2)	(C3)	(C4)
15013	P05-01.4.6-50	01	27
15013	P05-01.4.6-50	01	28
15013	P05-01.4.6-50	01	29
15013	P05-01.4.6-50	01	30
15013	P05-01.4.6-50	01	31
15013	P05-01.4.6-50	01	31

Southernmost system: JTRK
Wycisk system: 18w
50,000-288,71 m.m.m.

[illegible]